

Specifications

MATERIAL DATA	
MOLDED HEAD	Green, flame-resistant PVC or PUR
INSERT	PUR
CABLE TYPE	Gray, flexible PUR jacket
CONTACTS	Machined copper and tin over gold
CONTACT PLATING	Copper and tin over nickel
SHELL	N/A
WIRE GAUGE	#22 AWG
COUPLING NUT	Copper and tin over nickel
CABLE OUTER DIAMETER	4.5 mm
ELECTRICAL DATA	
CONTACT RESISTANCE	≤ 5 mΩ
ELECTRICAL ISOLATION	1500 VAC
CURRENT RATING	4 A
VOLTAGE RATING (4/5 pole)	300 VDC/60 VDC
ENVIRONMENT DATA	
PROTECTION CLASSES	IP68/69K
TEMPERATURE RANGE	-13 °F to +212 °F

Gray PUR Micro Cordsets

12 mm receptacle
DC sensor compatibility

- Single key
- Gray PUR cable jacket
- #22 AWG
- Female or male connection
- 4- and 5-pin
- Halogen free



Cordsets Micro Cordsets

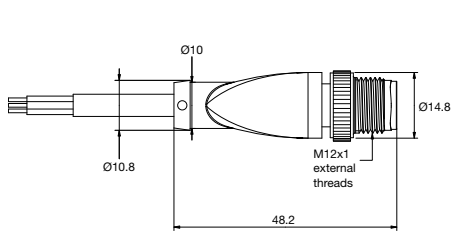

Male

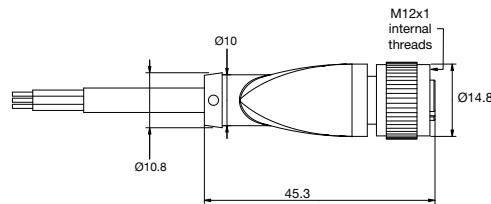
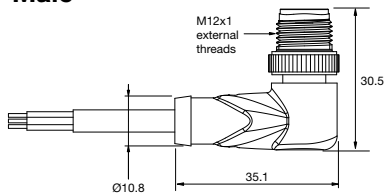

Female

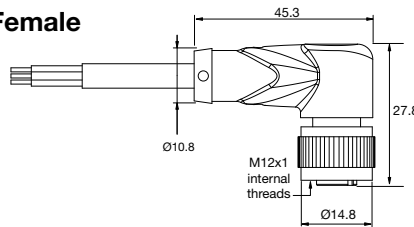

Model Number Selection						
Face View (female)	Color Code	Length (m)	Female Straight	Female Right Angle	Male Straight	Male Right Angle
	1. Brown	2	V1-G-2M-PUR ⚡	V1-W-2M-PUR ⚡	V1S-G-2M-PUR ⚡	V1S-W-2M-PUR ⚡
	2. White	5	V1-G-5M-PUR ⚡	V1-W-5M-PUR ⚡	V1S-G-5M-PUR ⚡	V1S-W-5M-PUR ⚡
	3. Blue	10	V1-G-10M-PUR ⚡	V1-W-10M-PUR ⚡	V1S-G-10M-PUR ●	V1S-W-10M-PUR ●
	4. Black	15	V1-G-15M-PUR ●	V1-W-15M-PUR ●		
	5. Not used	20	V1-G-20M-PUR ●	V1-W-20M-PUR ●		
	1. Brown	2	V15-G-2M-PUR ⚡	V15-W-2M-PUR ⚡		
	2. White	5	V15-G-5M-PUR ⚡	V15-W-5M-PUR ⚡		
	3. Blue	10	V15-G-10M-PUR ⚡	V15-W-10M-PUR ⚡		

- ⚡ Stocked item
 - Typical delivery 4 weeks or less
- Consult factory for all other models

Subject to modifications without notice

Pepperl+Fuchs Group
www.pepperl-fuchs.com

USA: +1 330 486 0001
fa-info@us.pepperl-fuchs.com

Germany: +49 621 776 0
fa-info@de.pepperl-fuchs.com

Copyright Pepperl+Fuchs
Singapore: +65 6779 9091
fa-info@sg.pepperl-fuchs.com

PEPPERL+FUCHS
SENSING YOUR NEEDS